



# Parts list Spiritello

## CONTENT

Ordering information .....	3
Parts order example.....	4
Steam boiler heater side (front) .....	5
Steam boiler HX-side (rear) .....	6
Coffee boiler front side .....	7
Coffee boiler rear side -1 .....	8
Coffee boiler rear side -2 .....	9
Coffee boiler rear side -3 .....	10
Switch mechanism and coffee-boiler mounting.....	11
Hinge block.....	12
Group head and piston .....	13
Group cage .....	14
Cylinder.....	15
Lever and lock.....	16
Steam wand .....	17
Steam valve, twist knob.....	18
Hot water wand.....	19
Water supply and pump.....	20
Pressure reducer.....	21
Fill block.....	22
Mix block.....	23
One-way expansion assembly and pressure gauge .....	24
Water waste .....	25
Controller items.....	26
Display .....	27
Other electrics .....	28
Pressure sensing .....	29
Water tank.....	30
Body panels.....	31
Rear panel.....	32
Copper tubing.....	33
Portafilter .....	34

Explanation for tables:

nip	not in picture
s.st.	stainless steel
#	frame number of machine
article code	Cannot be ordered. Replacement parts are mostly available (see remark).
Knnnnn-vv	The Knnnnn denotes the part, the -vv is used for version updates, -00 identifying the version that was originally used. The same number with extension -01 would be 1-on-1 replacement of the original part.

Order parts via: [spareparts@keesvanderwesten.com](mailto:spareparts@keesvanderwesten.com)

See "Ordering information" and "Parts order example" on pages 3 and 4.

**When ordering parts, specify the machine number the part is meant for.  
Refer to this parts-list revision date when ordering.**



## Ordering information

**Please note that this parts-list makes use of new parts numbers for most parts. The identification of the nuts, bolts, washers, etc. has remained unchanged.**

**Although the old numbers may still work for most parts, we cannot guarantee that we send the correct parts when you do not use the new numbers.**

When ordering spare parts directly from Kees van der Westen we ask you to send your parts list to [spareparts@keesvanderwesten.com](mailto:spareparts@keesvanderwesten.com) as comprehensive as possible to minimise the chance of mistakes in the delivered parts. Include the machine model, type, and machine number if the parts order concerns a specific machine, also include the parts-list version you consulted.

The list should state amount, parts number and short description, see the example on the next page.

You can download the different parts lists:

Spirit: <http://www.keesvanderwesten.com/assets/spirit-parts-list.pdf>  
Mirage: <http://www.keesvanderwesten.com/assets/mirage-parts-list.pdf>  
Speedster: <http://www.keesvanderwesten.com/assets/speedster-parts-list.pdf>  
Slim Jim: <https://www.keesvanderwesten.com/assets/slimjim-parts-list.pdf>  
Slim Jim Idrocompresso: <https://www.keesvanderwesten.com/assets/slimjim-idrocompresso-parts-list.pdf>

If the parts list is not conclusive, seek contact with [support@keesvanderwesten.com](mailto:support@keesvanderwesten.com) before ordering.

### One recipient please

When ordering parts or putting forward a question about parts, please address only one recipient on our side. When more employees receive the same email/request it is possible that all or none of the recipients feel responsible to act.

### Receive parts

To receive your spare parts order, we need your full details, see example below:

- Billing address
- Delivery address
- Contact person
- Telephone number(s)
- E-mail address

As we do not know the final UPS shipping costs upon sending your order, we will bill you after these costs are known to us.

So you will receive the goods first and the invoice afterwards.

### Payment

As for the payment of your order. Payment can be settled with PayPal or a bank wire transfer. We do not accept direct credit card transactions.

If you have a PayPal account set up it should be settled rather quickly. We could send you a payment request which takes care of it almost instantly.

A bank wire transfer is also possible, but we do not know if your bank charges additional costs and/or fees.

Please let us know which option you prefer. If you would like to pay with PayPal, we kindly ask you to inform us which email address we may send our request.





## Boilers

### Steam boiler heater side (front)

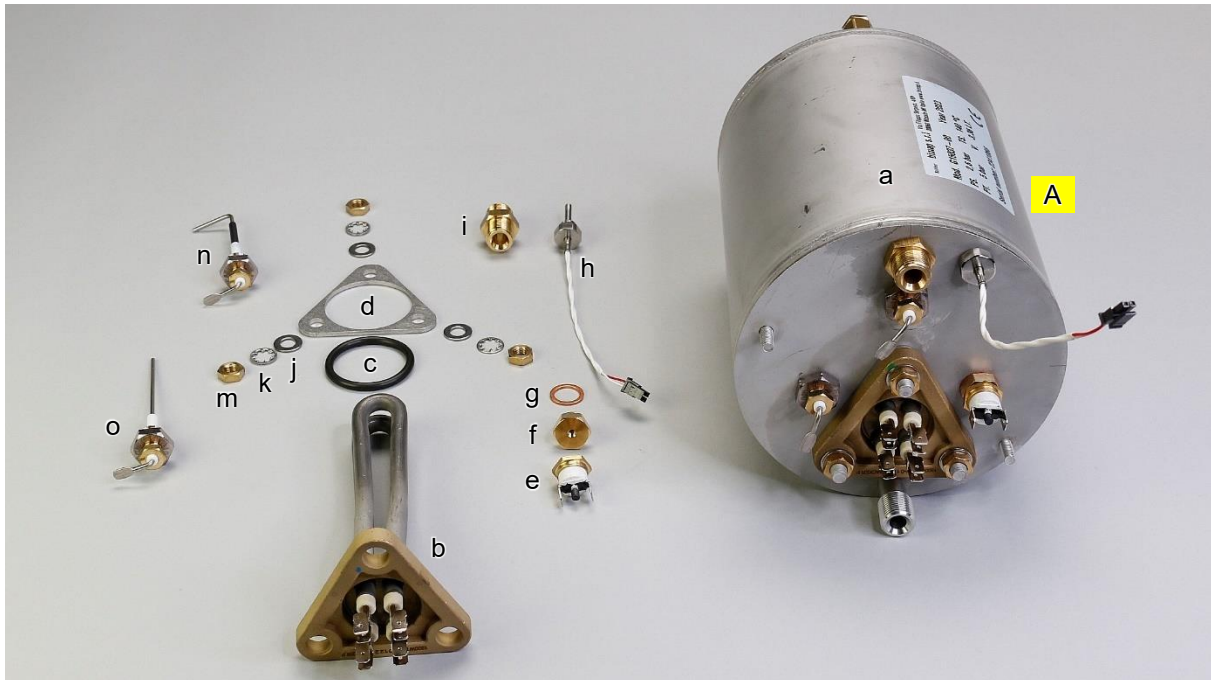

	part no.	short description	remark
<b>A</b>	<b>K01523-10</b>	<b>Assembly: steam boiler with s.st. connections (S20, RE)</b>	without sensor "h"
a	K01524-06	steam boiler, bare; s.st. (model 2009 with all s.st. connections)	
b	K01599-04	heating element 2x900W; 230Vac, faston (Backer)	
c	K01656-02	O-ring Ø39x4.5mm; FKM (gasket for heating element)	
d	K01676-00	triangular O-ring spacer for s.st. boiler, 3mm thick; s.st.	
e	K01597-00	overheat safety switch 145°C M4; manual re-set	
f	K01704-00	plug 1/4M-M4F; brass	
g	K00785-00	ring 1/4"; copper	
h	K02240-01	temperature sensor NTC, 1/8M, Ø4mm, 27mm; s.st. (Störk)	
i	K00719-00	fitting 3/8M-3/8M; brass	
j	C-RS-M8	washer din125A M8; s.st.	
k	C-RO-M8	lock washer din6797J M8; s.st.	
m	K01703-00	nut M8, 5mm thick; brass	
n	K01601-00	level probe (short - 125mm) bent with rubber, Complete	operational level
o	K00802-00	level probe 125mm; s.st., faston	safety level
nip	C-MV-M8X24-M	connection nut din6334 M8x24; brass, instead of upper "m"	bespoke element cap + mounting
	VK03935-00	heating element cap; using M8 bolt; Spiritello	
	C-RO-M8	washer din125A M8; s.st.	
	C-BT-M8X12	bolt din933 M8x12; s.st.	



## Boilers

### Steam boiler HX-side (rear)

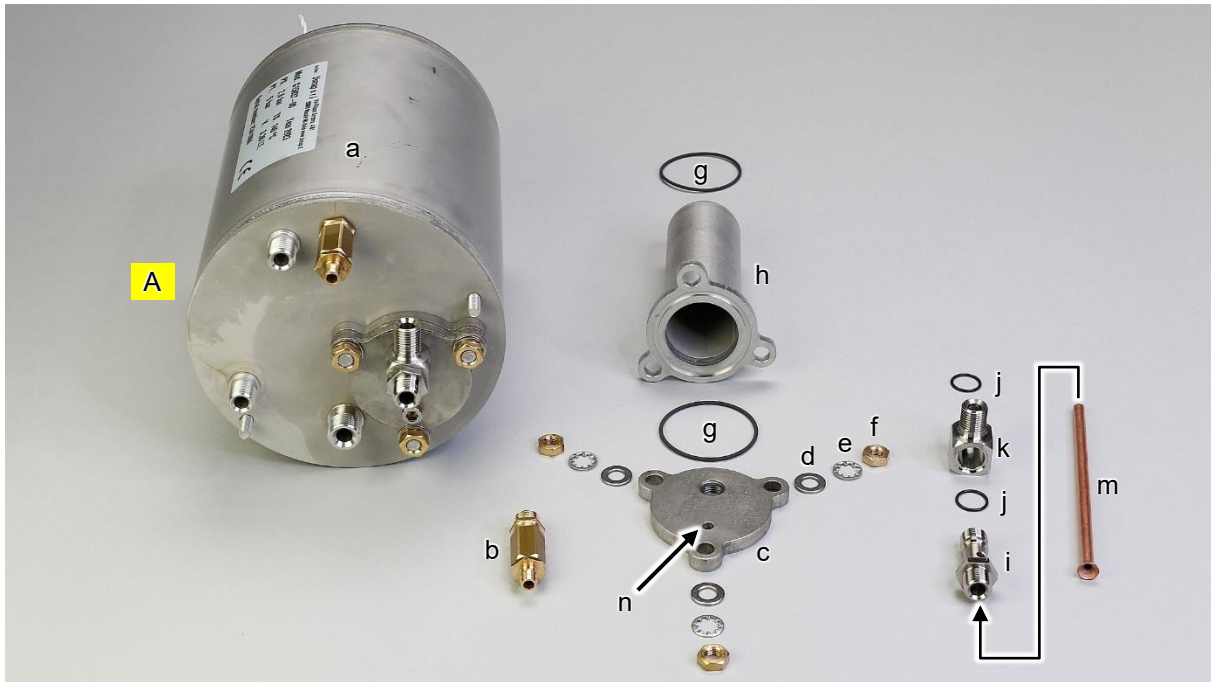

	part no.	short description	remark
<b>A</b>	<b>K01523-10</b>	<b>Assembly: steam boiler with s.st. connections (S20, RE)</b>	
a	K01524-06	steam boiler, bare; s.st. (model 2009 with all s.st. connections)	
b	K01535-00	overpressure relief valve 1/4M-hose pillar; 3.0 bar, brass	
c	K03099-00	heat exchanger flange; s.st. (S20, RE)	
d	C-RS-M8	washer din125A M8; s.st.	
e	C-RO-M8	lock washer din6797J M8; s.st.	
f	K01703-00	nut M8, 5mm thick; brass	
g	K03021-01	O-ring 47x2mm, FKM 90ShA; black (for HX S,S20,RE)	
h	K01559-02	heat exchanger, main body; s.st. (S, S20, RE)	
i	K02779-00	banjo bolt, 1/4"; s.st.	
j	K02788-00	O-ring Ø13.5 x 1.5mm; CS FKM (Viton) 75 ShA FDA	
k	K02780-00	banjo fitting, 1/4"; s.st.	
m	K03678-00	6mm copper tube: injection 150mm long; Spiritello	
n	K00823-00	washer M6; copper	drain bolt with seal for HX
	C-BZ-M6X10	Allen bolt din912 M6x10mm; s.st.	



## Boilers

### Coffee boiler front side

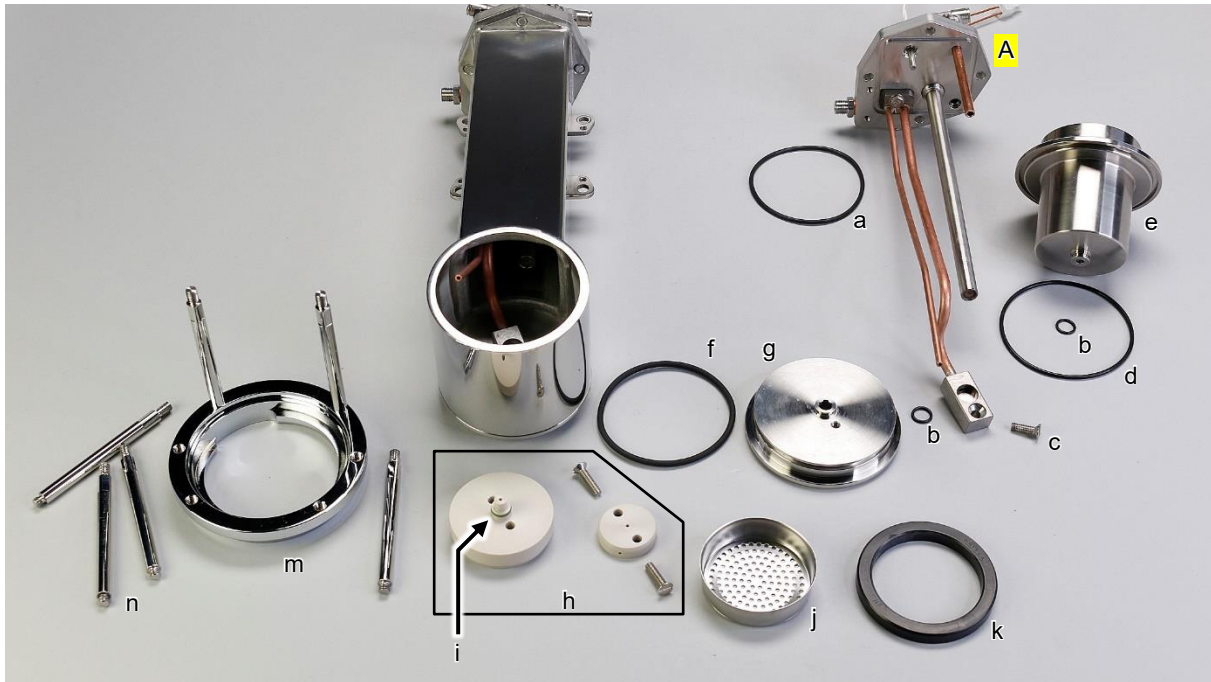

	part no.	short description	remark
A	K03921-01	Assembly: rear flange w. threaded connections for 0.8L boiler, semi-finished	see next page
a	K02154-02	O-ring Ø69.52 x 2.62mm; FKM ShA 75 (FDA); flange 0.8L boiler	
b	K01702-00	O-ring Ø9.1x1.6mm; FKM 75 ShA	
c	C-SC-M5X16	countersunk screw din963 M5x16; s.st.	
d	K03135-00	O-ring Ø75x2.5mm; FKM; FDA; top of group, standard size	
e	K02125-01	cylinder Idrocompressore group; s.st. (Ji, RE)	
f	K01695-01	O-ring Ø71.44x3.53mm; FKM, group base, standard size	
g	K01690-03	group base, O-ring seal version; s.st.	
h	K01700-03	dispersion set; beige PEEK (base, plate, O-ring, screws)	
i	K00837-01	O-ring Ø5.7x1.9mm; FKM, green or black	
j	K00824-00	group shower screen; s.st., KvdW logo	
k	K00826-00	group ring; 8.0mm (Arinca)	
m	K01697-02	group bayonet; chromed brass (without rods)	
n	K03429-00P	group head rod with tool-grip; polished, s.st. (J-i, RE)	



## Boilers

### Coffee boiler rear side -1

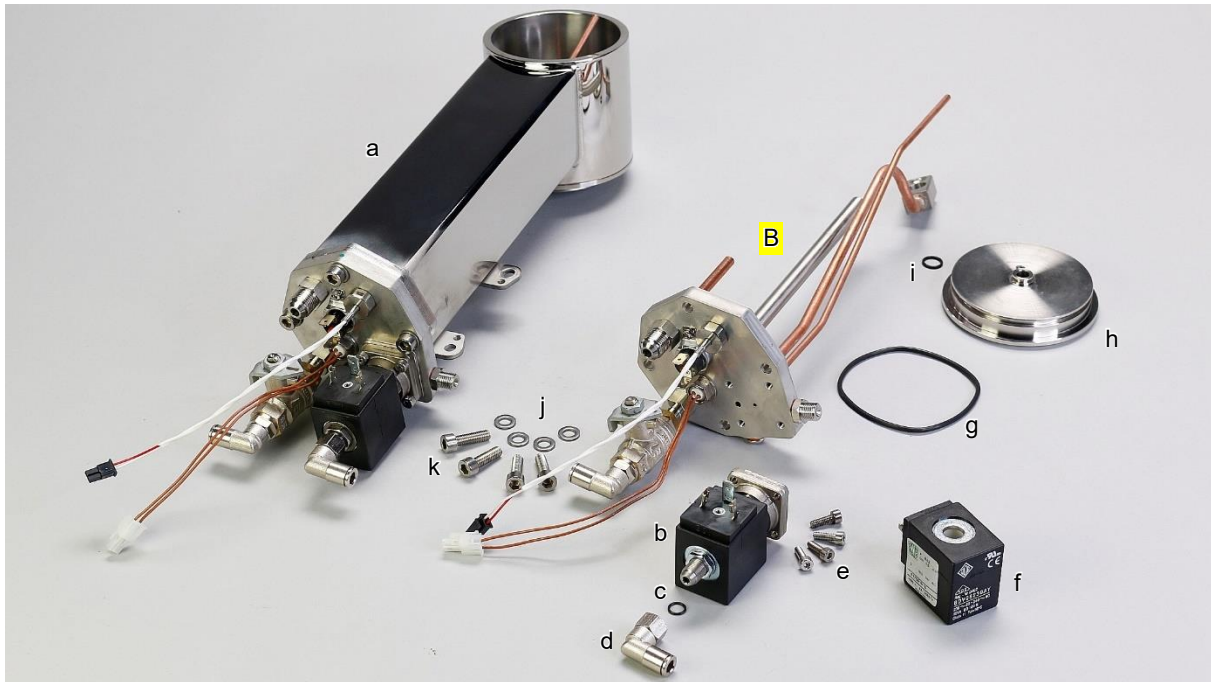

	part no.	short description	remark
B	K03921-01	Assembly: rear flange w. threaded connections for 0.8L boiler	see next page
a	K02139-00	coffee boiler 0.8L; s.st. partly polished	only main body
b	K02996-00	special 3-way flange valve, orifice 1.5mm; s.st., 230V (ODE)	
c	K02236-00	O-ring Ø6.8 x1.2mm; FKM 75ShA, FDA	
d	K02281-00	push-in fitting, elbow 1/8F - 6mm; Ni-plated brass	
e	C-BZ-M4X12	Allen bolt din912 M4x12mm; s.st.	
f	K00397-00	coil 230Vac, 16VA, for ODE solenoid valves	
g	K02154-02	O-ring Ø69.52 x 2.62mm; FKM ShA 75 (FDA); flange 0.8L boiler	
h	K01690-03	group base, O-ring seal version; s.st.	
i	K01702-00	O-ring Ø9.1x1.6mm; FKM 75 ShA	
j	C-RS-M6	washer din125A M6; s.st.	
k	C-BZ-M6x20	Allen bolt din912 M6x20mm; s.st.	



## Boilers

### Coffee boiler rear side -2

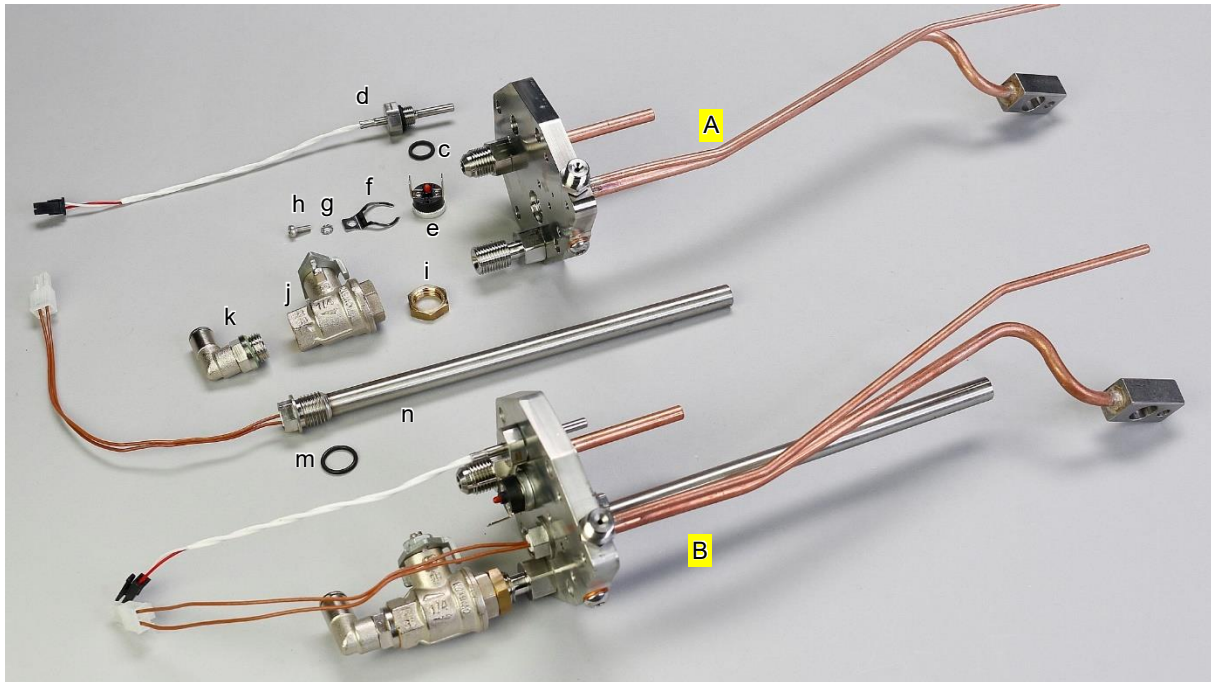

	part no.	short description	remark
A	K02215-05	Assembly: rear flange with lines and fittings for 0.8L boiler	see next
B	K03921-01	Assembly: rear flange w. threaded connections for 0.8L boiler	= A + d...n
c	K03547-00	O-ring 9.25X1.75; FKM75 (temperature sensor)	
d	K02240-01	temperature sensor NTC, 1/8M, Ø4mm, 27mm; s.st. (Störk)	with O-ring
e	K02234-00	thermal cut-out, 105°C; manual reset	
f	K02211-00	C-clip for thermal cut-out;	
g	C-RT-M3	lock washer din6798A M3; s.st.	
h	C-SK-M3X08	Phillips screw din7985 M3x8; s.st.	
i	K00680-00	flat nut 1/4; brass	
j	K03514-00	ball valve 1/4F-1/4F; nickel plated brass, custom handle	
k	K02279-00	push-in fitting, elbow 1/4M - 6mm; Ni-plated brass	
m	K02170-01	O-ring Ø11.8 x1.8mm; FKM, 75ShA; for M14 cartridge element	
n	K02172-00	cartridge element M14xØ10x200mm, 230Vac, 450W; s.st.	



## Boilers

### Coffee boiler rear side -3

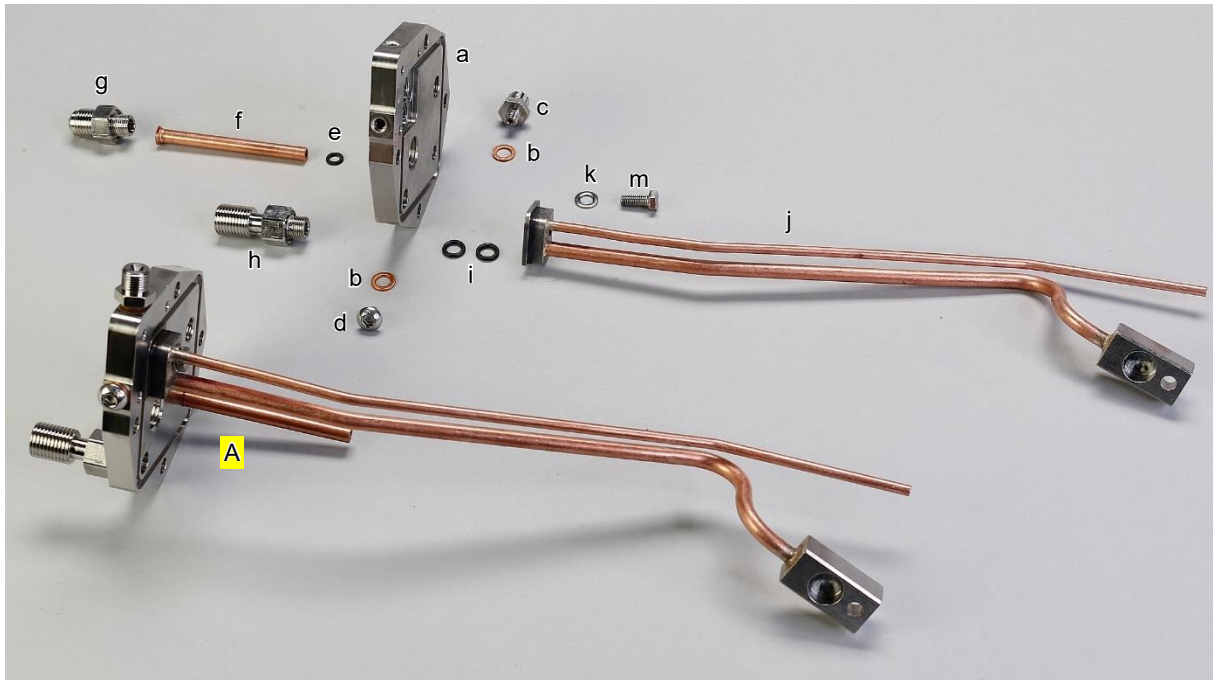

	part no.	short description	remark
A	K02215-05	Assembly: rear flange with lines and fittings for 0.8L boiler	
a	K03535-00	rear flange 0.8L boiler; s.st. (screw version)	
b	K00823-00	washer M6; copper	
c	K03533-00	adapter-fitting M6 to G1/8; 316L (rear flange, screw version)	
d	C-BI-M6X06	Allen screw Iso7380 M6x6; s.st.	
e	K00339-00	O-ring 4x1.5mm; Viton	
f	K03536-00	6mm copper tube: water supply injector 0.8L boiler (J, Re)	
g	K03531-00	fitting G1/8 to G1/4; for ball valve; 316L (0.8L boiler rear flange)	
h	K03532-00	Fitting G1/8 to G1/4; for ball valve; RVS361L; SJ rear flange	
i	K00791-01	O-ring Ø6.07x1.78mm; FKM75 (for flat-jet CD10)	
j	K04014-00	internal group lines for threaded flange (0.8L boiler)	
k	C-RS-A4-M5	washer din125A M5; s.st. A4	
m	C-BT-A4-M5X12	bolt din933 M5 x 12mm; s.st. A4	



## Lever group items

### Switch mechanism and coffee-boiler mounting

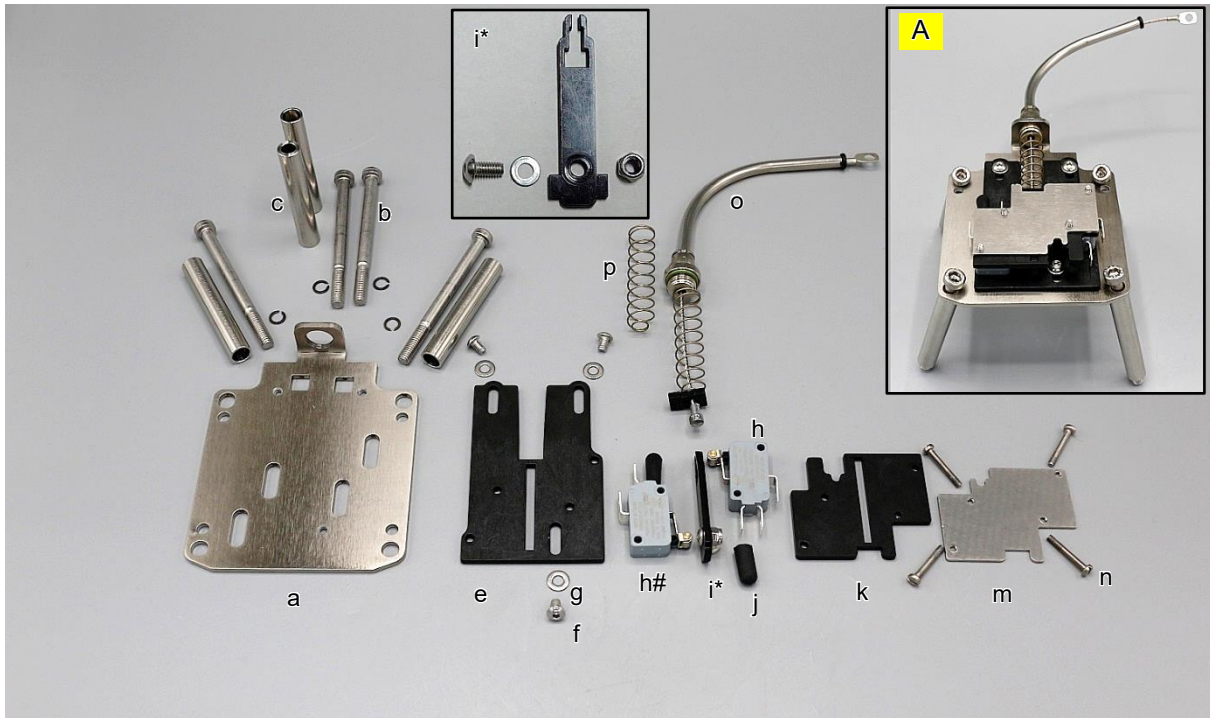

The coffee boiler is mounted with this bracket and 4 Allen bolts with stand-off tubes. The long Allen bolts have a low head for reason of tight space underneath the group-cover.

	part nr.	short description	
A	K03910-01	Assembly: switch mechanism; Idrocompresso low version	
a	K03154-02	Idro switch mechanism bracket; s.st.	
b	C-BZ-M6X75L	Allen bolt din6912 M6x75mm; s.st.; <b>low head version</b>	
c	K03518-00	Idro switch mechanism standoff tube 10x6,2x59.9mm; s.st.	
d	K03520-00	retaining ring shaft 6mm; CK67, phosphated	
e	K03158-03T	Idro switch mechanism lower guide plate; black POM (tumbled)	
h	K03050-00	micro-switch, SPDT, roller lever; 16A/250V	
h#		micro-switch (h) with insulating cap (j)	
i*	C-BI-M4X08	Allen screw Iso7380 M4x8; s.st.	
	K03426-02T	Idro switch mechanism slider; black POM (tumbled)	
	C-RS-M4-0.5	washer M4, 0.5mm thick; s.st. (per July 2025)	
	C-MB-M4	locknut din985 M4; s.st.	
j	C-ED-4.8	insulating cap Di=4.8, Li=14.2; thermoplastic elastomer	
k	K03425-02T	Idro switch mechanism upper guide plate; black POM (tumbled)	
m	K03424-01	Idro switch mechanism top plate; s.st.	
n	C-SG-M3X20	machine screw din84 M3x20; s.st.	
o	K03909-00	assembly: Idro low profile Bowden cable with eyelet and end-stop	
p	K03159-01	spring CSS 0.75x12.5x54.5; s.st., conical	

\* In version K03910-01 the bolt on slider K03426 has a washer on the head side and size has changed from M4x6 to M4x8.



## Lever group items

### Hinge block

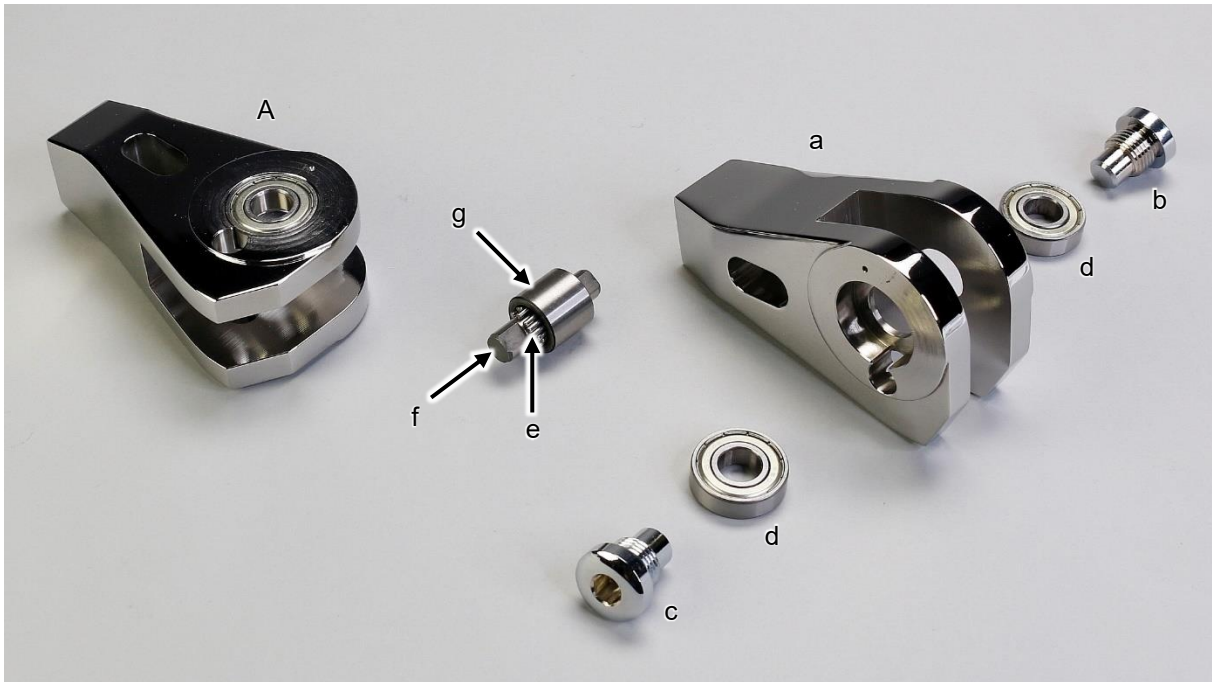

	part no.	short description	remark
A		hinge block with bearings	
a	K03403-01P	hinge block Idro; polished s.st. (Ji, RE)	
b	K00586-00	axle bearing screw; chromed brass, right	
c	K00585-00	axle bearing screw; chromed brass, left	
d	K00574-00	large bearing in hinge block Idrocompressore (Mi, Ji, RE)	
e	K00583-00	set (18 pcs) of needles for centre bearing, no axle, Idro group	
f	K00575-00	bearing axle Ø4 x10mm; steel (Idro group)	
g	K00584-00	outer bearing shell 14Dix20Dox18h; tempered st. (Idro group)	



## Lever group items

### Group head and piston

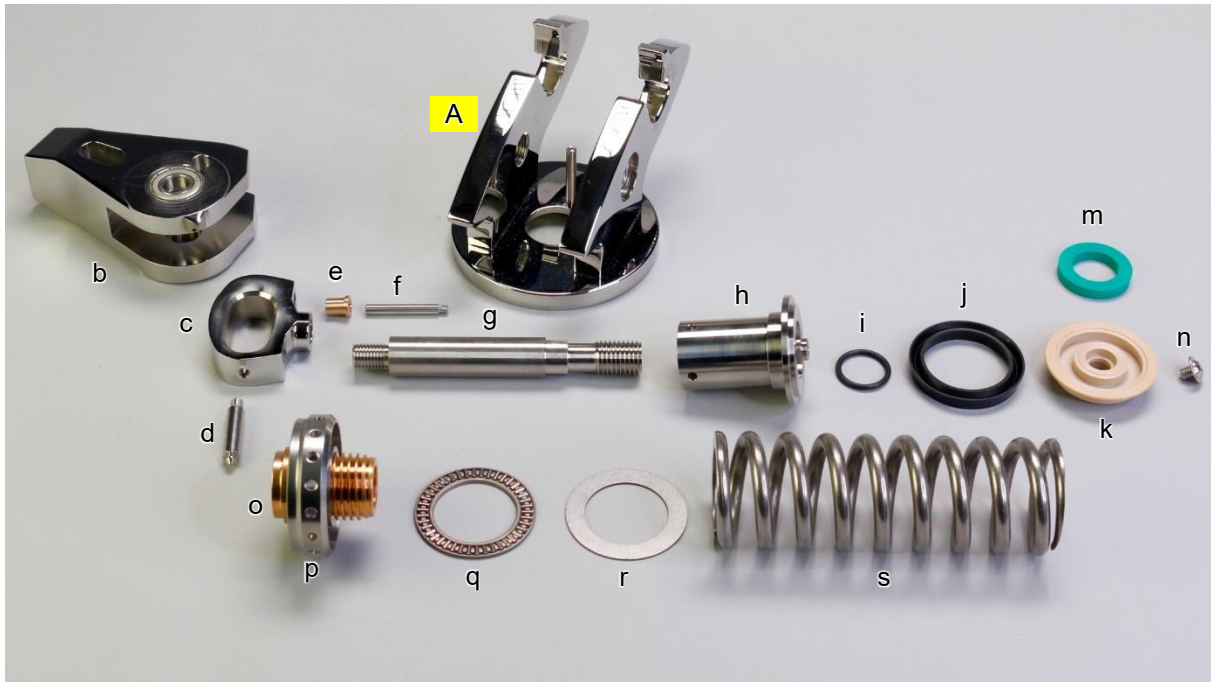

	part no.	short description	remark
<b>A</b>		<b>Assembly: group-lid with locking ears and guide pin</b>	
b		hinge block Idro; polished s.st. (Ji, RE) with bearings	see previous page
c	K03964-00P	oval bracket on top of piston rod SJ Idro; s.st. (RE)	
d	K03720-00	standoff for switchkabel (low version Idro); s.st. (RE)	
e	K03945-00	guide bush in oval bracket; brass	
f	K03946-00	guide pin in group-lid; s.st.	
g	<del>K03896-00</del>	piston-rod (low version Idro); s.st. (RE)	replaced by next
	K03896-01	piston-rod (low version Idro); s.st. (RE)	
h	K03892-00	piston part 1 (low version Idro); s.st.	
i	K00616-00	O-ring Ø20.3x2.62mm; FKM75	
j	K00566-03	V-ring 52x40x7mm; Viton (Idrocompresso piston gasket)	
k	<del>K03893-00</del>	piston part 2 (low version Idro); PEEK	
	K03893-01	piston part 2 (low version Idro); PEEK (without Cam-lock ring)	
m	K03586-00	Cam-Lock ring 3/4"; green FKM (quick-fill Idro)	obsolete
n	C-BK-M6X06	Allen bolt with collar, iso7380-2 M6x6; s.st.	
o	<del>K02127-04T</del>	guide bush, threads 28x3; bronze (Ji, RE)	replaced by next
	K02127-02T	guide bush, threads 28x3, bronze (Ji, RE)	use with O-rings
	K04032-00	O-ring Ø18x1.5mm; FKM80	inside K02127-02T
p	K03915-00	spring adjusting disk Idrocompresso, suitable for bearing; s.st.	
q	K03918-00	needle bearing disk 35x52x1mm; (Idro spring adjuster disk)	
r	K03917-00	needle bearing 35x52x2mm; used in Idro spring adjuster disk	
s	K03431-01	spring for Idro, d=7mm, L=140mm, N=10; s.st. 1.4568 (Ji, RE)	



## Lever group items

### Group cage



Above-left an assembled group cage without flange ring and lower click flanges.

	part no.	short description	remark
a	K03894-00P	group cage Idro (low ver.) d=64, D=70, h=88.5; polished s.st.	
b	K03719-00T	upper click flange Idro (low version); polished s.st. (RE)	
c	K03898-00	conical pin DIN 1 B 1,5x10; s.st. A1	
d	VK03897-00P	ornate ring Di70.5xDo93xh3; polished s.st. (low version Idro)	
e	K03520-00	retaining ring shaft 6mm; CK67, phosphated	
f	K03721-00	ornate tube 10x2x22mm Idrocompressso; polished s.st.	
g	C-BZ-M6X35	Allen bolt din912 M6x35mm; s.st.	
h	K03919-00T	catch for shift cable; black POM, Idrocompressso	
	C-MF-M5	flange nut din6923 M5; s.st.	
i	C-BI-M5X06	Allen screw Iso7380 M5x6; s.st.	
j	K03404-00P	flange ring group cage Idro; polished s.st. (Ji, RE)	
k	K03142-01	lower click flange Idro; s.st. 3mm (Ji, RE)	



## Lever group items

### Cylinder



	part no.	short description	remark
a	K03404-00P	flange ring group cage Idro; polished s.st. (Ji, RE)	
b	K03135-00	O-ring 75x2.5mm; FKM; FDA; top of group, standard size	
c	K02125-01	cylinder Idro group; s.st. (Ji, RE)	
nip	K02125-02	cylinder Idro group, for use with centering O-ring; s.st. (Ji, RE)	
	K04018-00	O-ring Ø52,4x3,53mm; black	
d	K01702-00	O-ring Ø9.1x1.6mm; FKM 75 ShA	



## Lever group items

### Lever and lock

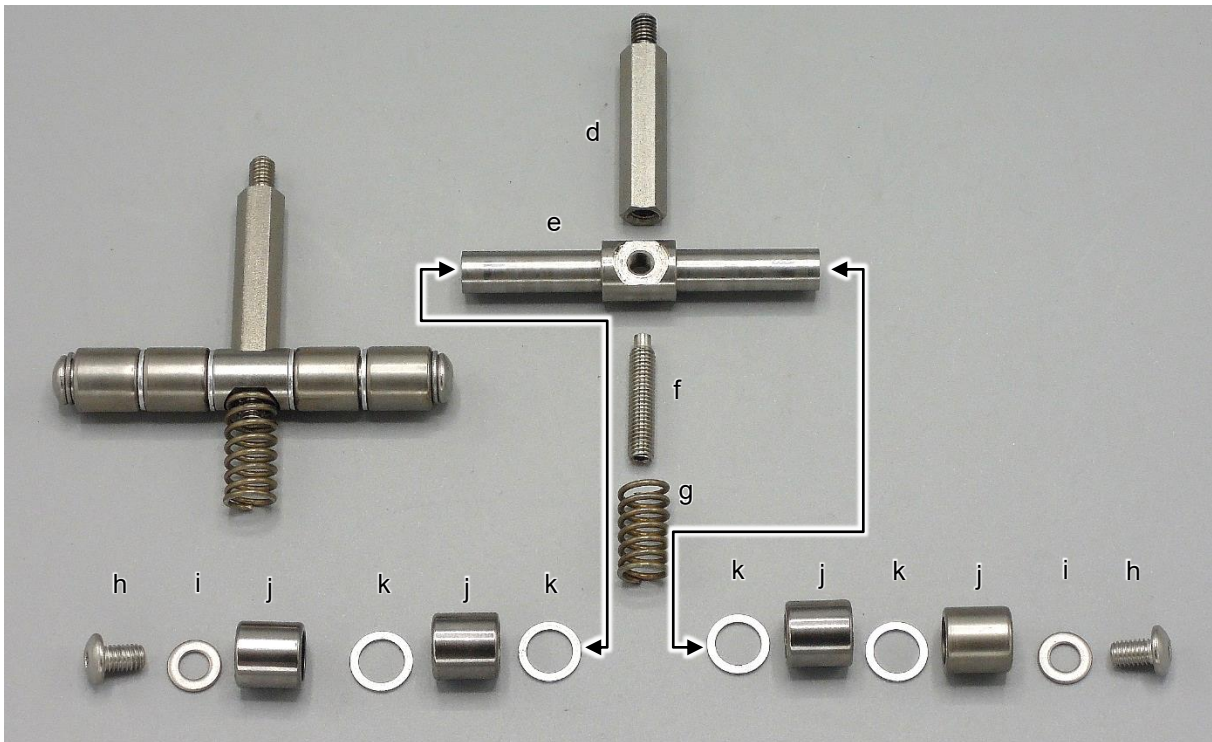
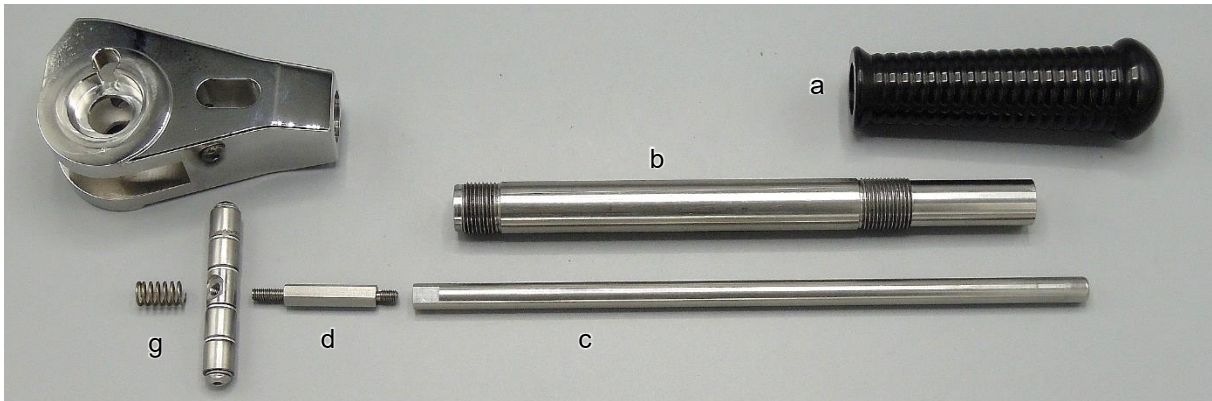

	part no.	short description	remark
a	K03726-00	lever-handle Idrocompressor; Nylon PA6, black	
nip	K03727-00	lever-handle Idrocompressor; Nylon PA6, Ivory coloured	on request only
	K03819-00	lever-handle Idrocompressor; wood, American Walnut	
	K03820-00	lever-handle Idrocompressor; wood, American Oak	
b	K02130-01P	lever-tube Idro; polished s.st. (J, RE)	
c	K02128-00	lock release rod Idro; s.st. (J, RE)	
d	C-AH-M5x35	threaded standoff pillar, M5x35mm; s.st.	
e	K02120-00	axle for needle bearings Idro-lever lock; s.st. (Ji, RE)	
f	C-SST-M5x25	set screw with dog point din915 M5x25; s.st.	
g	K03423-00	spring CSS 1.2x8.45x20mm; s.st. (Idro lever unlock mech.)	
h	C-BI-M5x08	Allen screw iso7380 M5x8; s.st.	
i	C-RS-M5	washer din125A M5; s.st.	
j	K03396-00	needle bearing d=8, D=12 W=12mm; steel; Idrocompressor	
k	C-RA-08	sealing ring din7603A 8X11.5, h=1; Aluminum	



## Steam and Hot water

### Steam wand

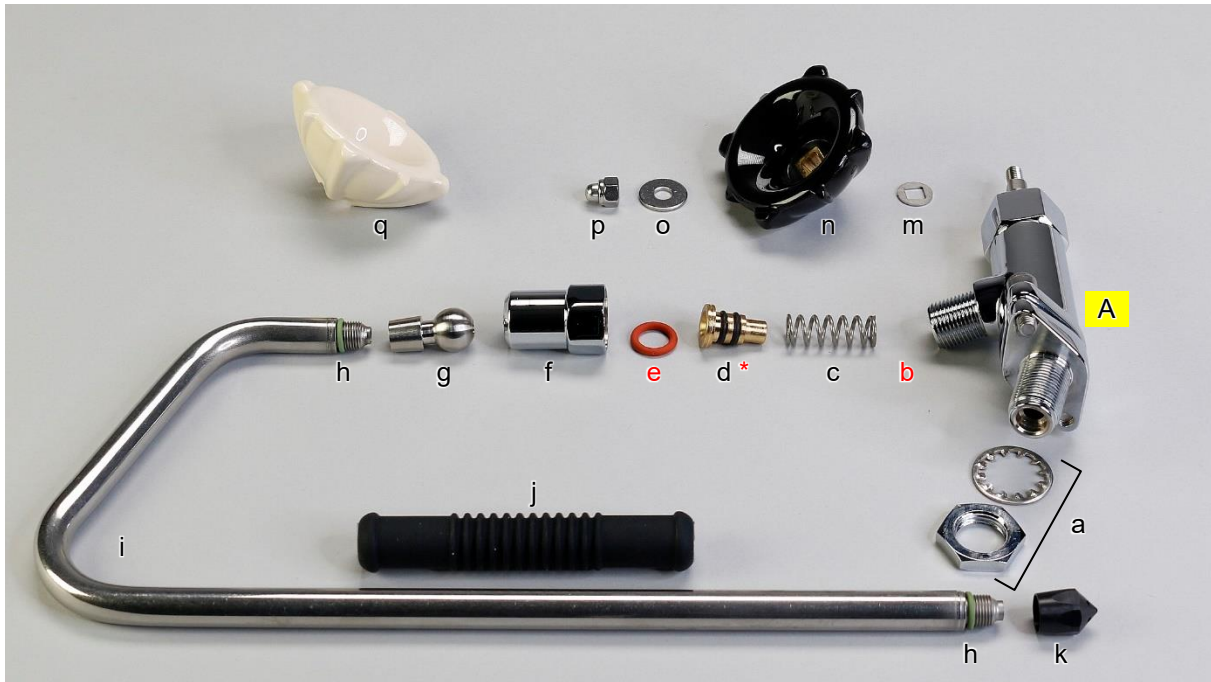

	part no.	short description	remark
A	K00685-01	steam valve; chromed brass with lock washer and nut	
a		flat nut 3/8; chromed brass and lock washer 3/8; s.st.	
b	K00855-00	ring 3/8"; Teflon (21x16.8x2mm)	not on photo
c	K00849-00	spring; s.st. (against trumpet plunger, appr. 1.5x8x30mm)	
d	K00851-00	trumpet plunger; brass, complete with two O-rings	
*	K00850-00	O-ring Ø7.2 x 1.9mm; EPDM	O-ring only
e	K00852-00	O-ring (appr. Ø10.5 x 2.7mm); red silicone	
f	K00853-00	ball-joint nut 22mm; chromed bronze	
g	K03440-00	ball joint for Zappo steam wand; s.st.	
h	K03596-00	O-ring Ø7.65x1.78mm; FKM 75, green (Zappo steam wand)	
i	K03595-00	Zappo double walled steam wand Spiritello; s.st. (no tip)	
j	K03354-00	insulation sleeve for Zappo steam wand; rubber, 100mm	
k	K03602-00	steam tip, 4x 1.6mm; PEEK, black (Zappo steam wand)	
	K03517-00	steam tip, 4x 1.2mm; PEEK, black (Zappo steam wand)	
m	K02733-00	washer Ø13mm, inner square 6.6mm; s.st.	
n	K02728-00	steam valve knob, tulip model; Nylon PA6, black	
o	C-RC-M6	fender washer din9021 M6; s.st.	
p	C-MZ-M6	lock nut din986 M6; s.st., dome cap	
q	K02119-00	steam valve knob, tulip model; Nylon PA6, ivory color	
nip	K03196-00	steam valve knob, tulip model; Nylon PA6, black, RAW	
	K03815-00	steam valve knob, tulip model; wood, American Walnut	on request only
	K03816-00	steam valve knob, tulip model; wood, American Oak	
	K00868-00	Service kit steam/water wand (2xK00850, K00852, K00855)	



Steam valve, twist knob

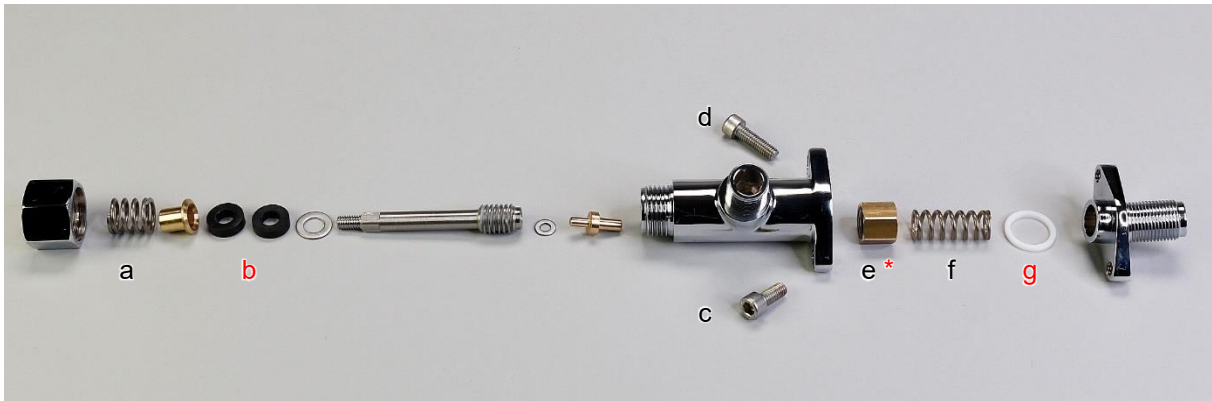

Items without letter are not separately available

	part no.	short description	remark
	K00685-01	steam valve; chromed brass with lock washer and nut	see previous page
a	K00822-00	spring; s.st. (appr. 2x12x17mm)	
b	K00861-00	ring 15.5x7.5x5x4mm EPDM (seal on steam valve shaft)	
c	C-BZ-M6x14	Allen bolt din912 M6x14mm; s.st.	
d	C-BZ-M6x20	Allen bolt din912 M6x20mm; s.st.	
e	K00873-00	plunger in steam valve; brass, with FKM sealing disk	
*	K00871-00	sealing disk 13x4x4mm; FKM (on steam valve plunger)	disk only
f	K00821-00	spring; s.st. (appr. 2x9x31mm)	
g	K00860-00	ring 24x18x2mm; Teflon (between steam valve body and base)	
	K00874-00	Service kit steam valve (K00871, K00861 2x, K00860)	



Hot water wand

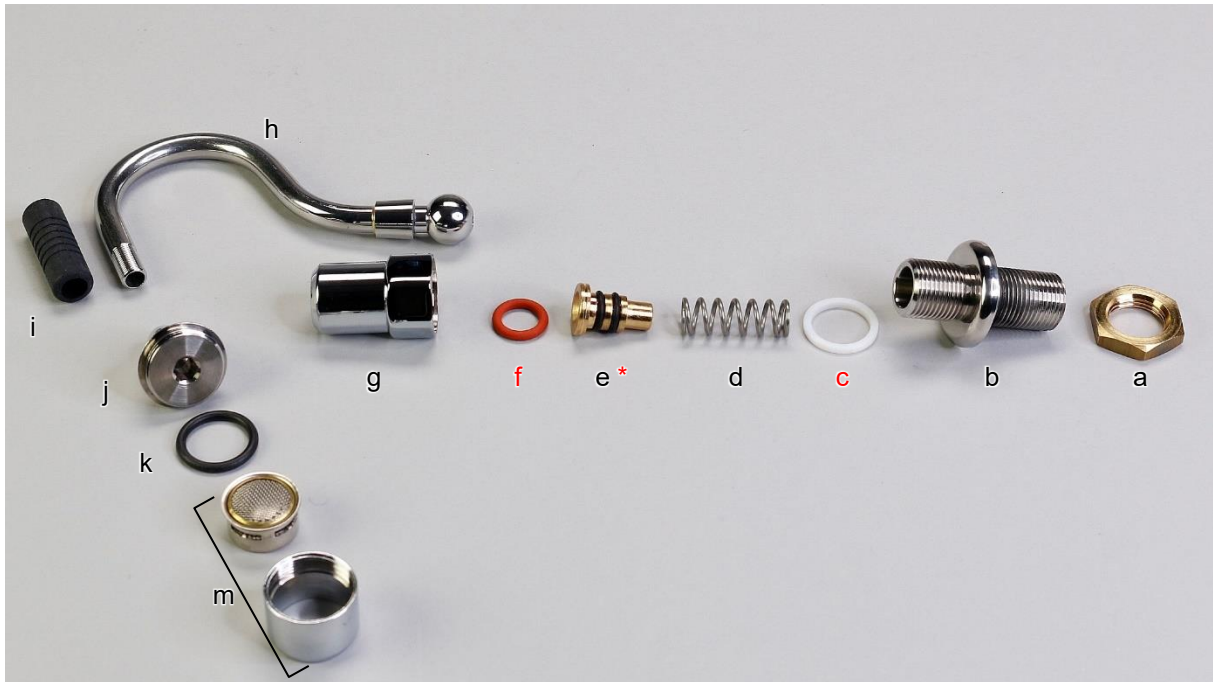

	part no.	short description	remark
a	K00284-00	flat nut 3/8", 6mm thick; brass	
b	K01451-01	front panel fitting (steam and water outlets); polished s.st.	
c	K00855-00	ring 3/8"; Teflon (21x16.8x2mm)	
d	K00849-00	spring; s.st. (against trumpet plunger, appr. 1.5x8x30mm)	
e	K00851-00	trumpet plunger; brass, complete with two O-rings	
*	K00850-00	O-ring Ø7.2 x 1.9mm; EPDM	O-ring only
f	K00852-00	O-ring (appr. Ø10.5 x 2.7mm); red silicone	
g	K00853-00	ball-joint nut 22mm; chromed bronze	
h	K03660-00	hot water wand Spiritello; polished s.st.	
i	K00862-00	rubber anti-burn sleeve; 34mm	
j	K00856-00	hot water wand tip; s.st. (mushroom shape)	
k	K00858-00	O-ring (appr. 16.9x2.7mm); EPDM (hot water screen assy)	
m	K00857-00	screen assembly on hot water wand tip; chrome plated brass	
	K00868-00	Service kit steam/water wand (2xK00850, K00852, K00855)	



## Water ways

### Water supply and pump

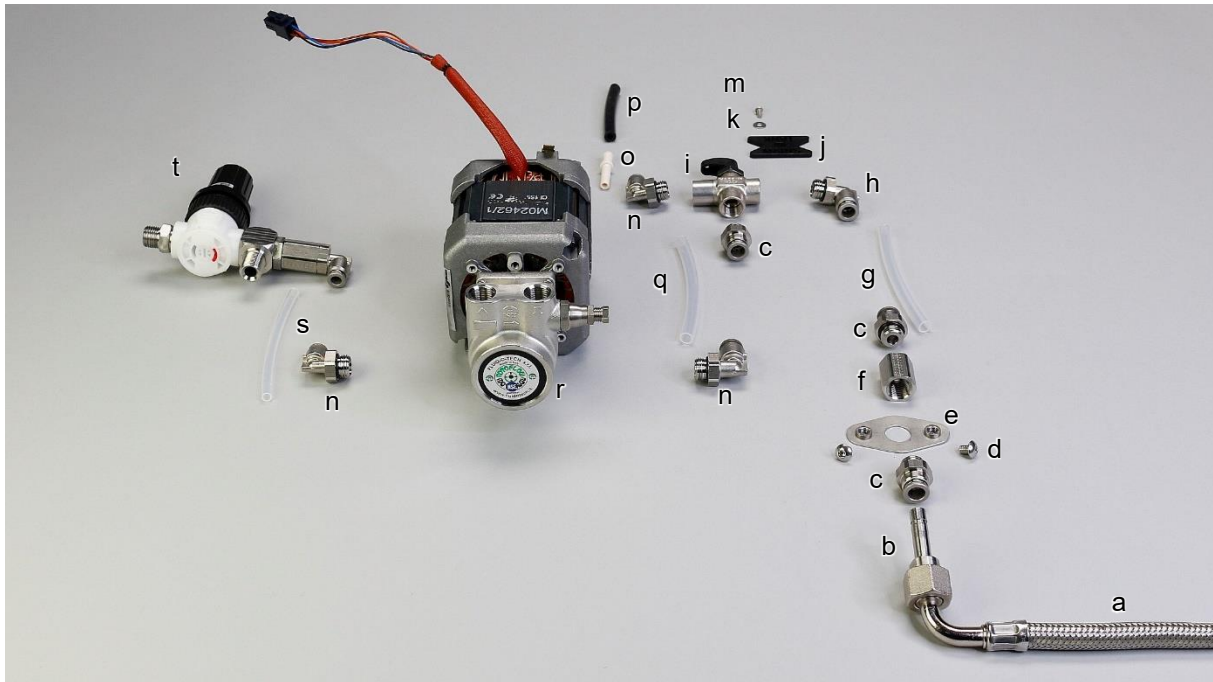

NB: hoses on photo do not have correct length.

	part no.	short description	remark
a	K00704-01	braided high pressure hose for water inlet, 2m (6,5')	
b	K03062-00	push-in adapter 3/8M - 8mm; s.st.	
	K03062-01	push-in adapter 3/8M - 8mm; s.st.	shorter pillar
c	K03779-00	push-in fitting, straight 1/4M - 6mm; s.st. 316L	
d	C-BI-M5X08	Allen screw iso7380 M5x8; s.st.	
e	K03739-01	mounting plate for supply fitting; Ø13,5; s.st. (RE)	
f	K03778-00	socket 1/4F; s.st. (RE)	
g	K03883-00	push-in hose, 6x8 mm; FEP, transparent, 200mm	
h	K03885-00	push-in fitting, elbow swivel, 1/4M - 8mm; s.st.	
i	K03767-00	3-way valve; 3x1/4F; s.st. (RE)	
j	K03895-00T	valve knob with text "tanks vs mains"; black POM (RE)	
k	C-RC-M3	fender washer din9021 M3; s.st.	
m	C-BI-M3X06	Allen screw Iso7380 M3x6; s.st.	
n	K03777-00	push-in fitting, elbow swivel, 1/4M - 6mm; s.st.	
o	K03886-00	push-in adapter, Ø6mm to hose-pillar Ø6mm; plastic	
p	C-HS-ZZ4X8	hose 4x8mm; black silicone, 180mm (water tank)	
q	K03883-00	push-in hose, 6x8 mm; FEP, transparent, 335mm	
r	K03751-01	Assembly: pump with motor 220-240Vac, 200W; Spiritello	
s	K03883-00	push-in hose, 6x8 mm; FEP, transparent, 210mm	
t	K03693-00	Assembly: pressure reducer Spiritello	



## Water ways

### Pressure reducer

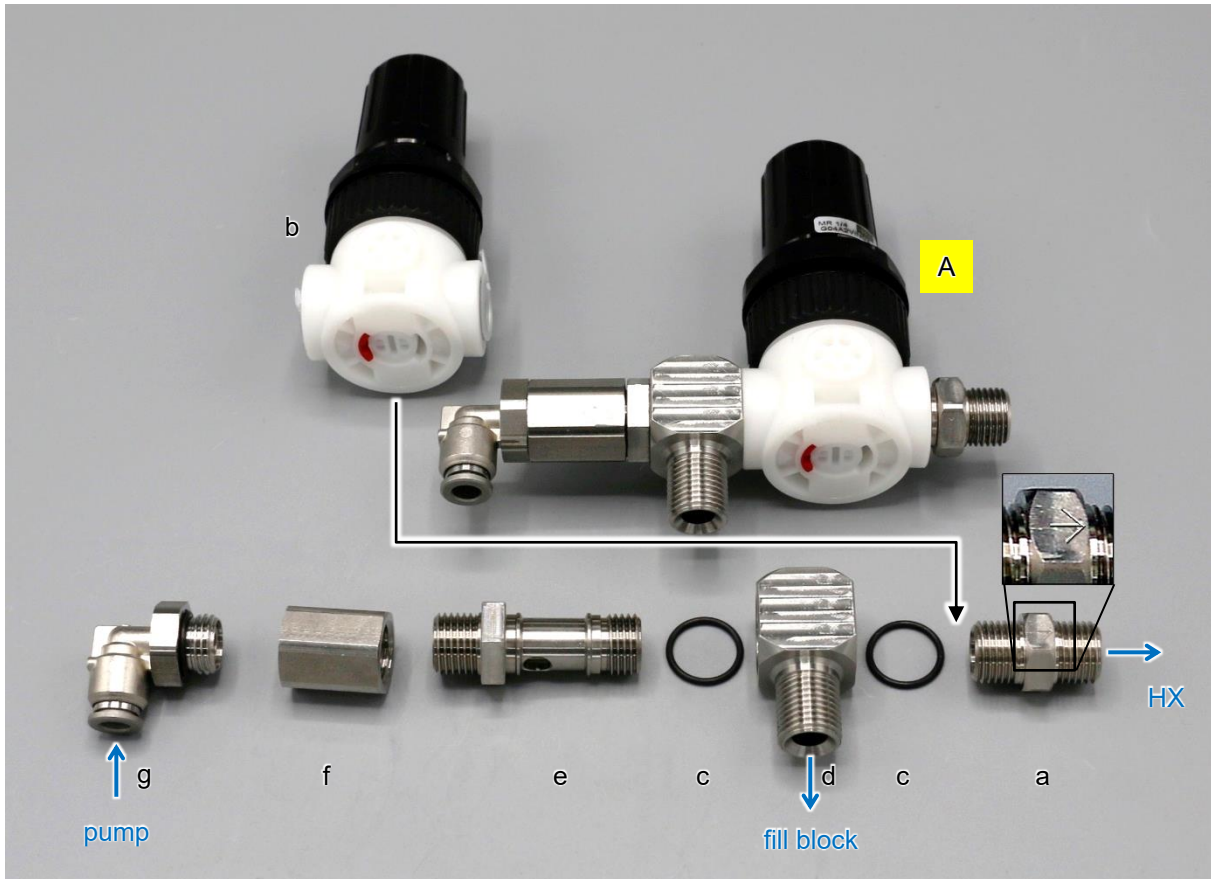

	part no.	short description	remark
A	K03693-00	Assembly: pressure reducer Spiritello	
a	K02235-00	1-way valve 1/4M-1/4M; s.st.	
b	K03472-01	pressure reducer 0-4 bar; G1/4; black knob; with bracket	
c	K02788-00	O-ring Ø13.5 x 1.5mm; CS FKM (Viton) 75 ShA FDA	
d	K02780-00	banjo fitting, 1/4"; s.st.	
e	K02779-00	banjo bolt, 1/4"; s.st.	
f	K03778-00	Socket 1/4"; s.st.; Spiritello	
g	K03777-00	push-in fitting, 90° swivel adaptor 1/4 Male – 6mm; s.st.	



## Water ways

### Fill block

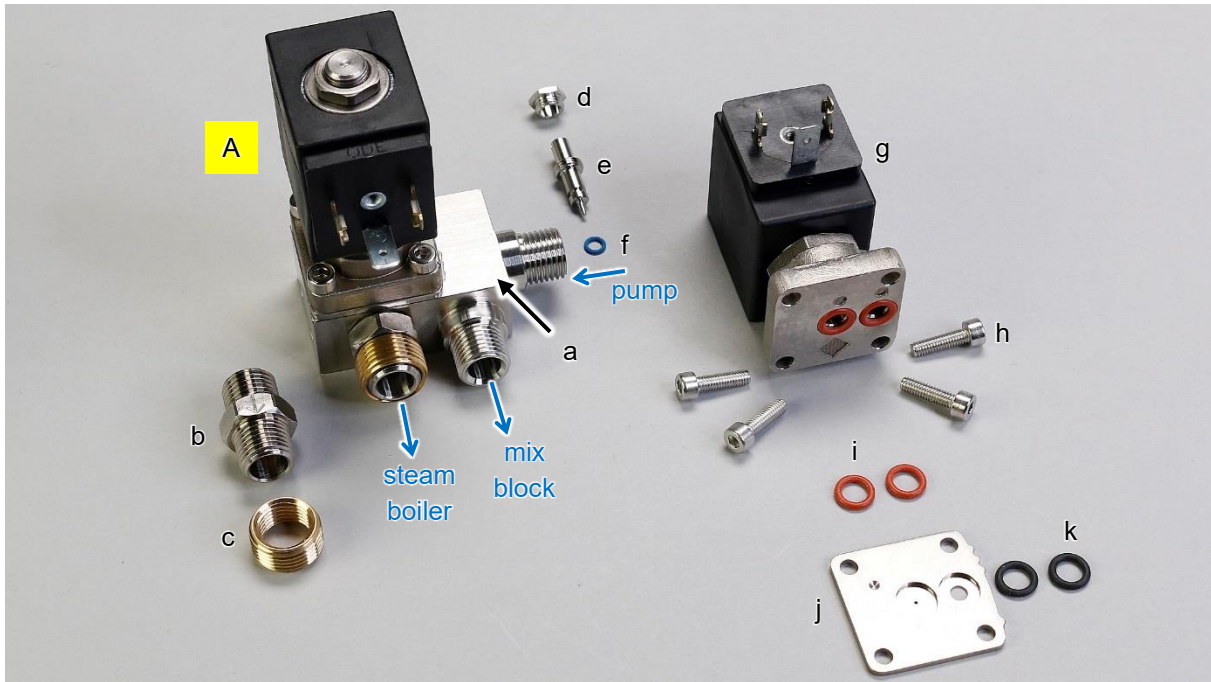

	part no.	short description	remark
A	K03105-02	Assembly: Fill block, (S20, RE)	
a	K03326-00	fill block including fittings; s.st. (S20, RE)	
b	K02235-00	1-way valve 1/4M-1/4M; s.st.	
c	L-V3814	thread adaptor; G3/8" - G1/4"; brass	
d	K02146-00	locking nut for jet needle ~Ø9x5mm; M8x0.75mm; s.st.	
e	K02145-00	jet needle Ø5x26mm with thread M8x0.75mm; s.st.	
f	K02369-00	O-ring Ø3.5x1.0 mm; FKM 80ShA, blue, FDA	
g	K02452-00	2-way flange valve, orifice 2.5mm; s.st.; coil 230V (ODE)	
h	C-BZ-M4X14	Allen bolt din912 M4x14mm; s.st.	
i	K03024-00	O-ring Ø6.07 x 1.78mm; silicone (for valve K02452-00)	
j	K01663-01	flat-jet CD10; 0.8mm; s.st.	
k	K00791-01	O-ring Ø6.07 x 1.78mm; FKM75 (for flat-jet CD10)	



## Water ways

### Mix block

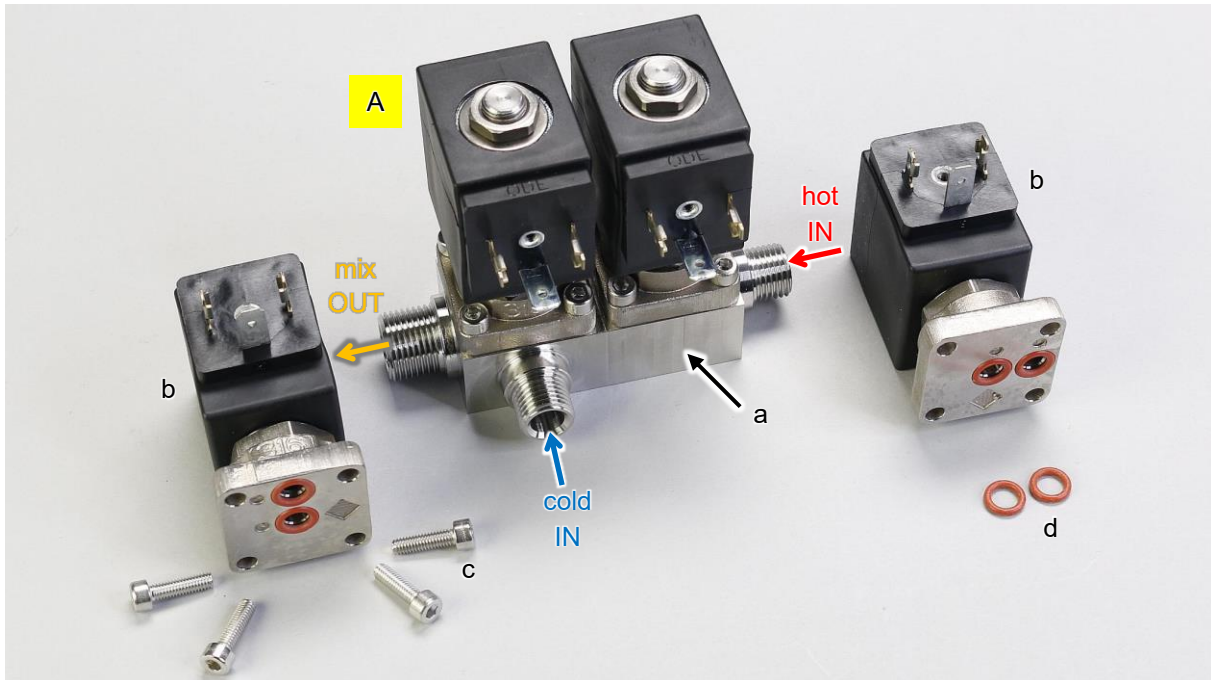

	part no.	short description	remark
A	K03108-01	Assembly: mix block (S20, RE)	
a	K03328-00	mix block, including fittings; s.st. (S20, RE)	
b	K02452-00	2-way flange valve, orifice 2.5mm; s.st.; coil 230V (ODE)	
c	C-BZ-M4X14	Allen bolt din912 M4x14mm; s.st.	
d	K03024-00	O-ring Ø6.07 x 1.78mm; silicone (for valve K02452-00)	



## Water ways

### One-way expansion assembly and pressure gauge

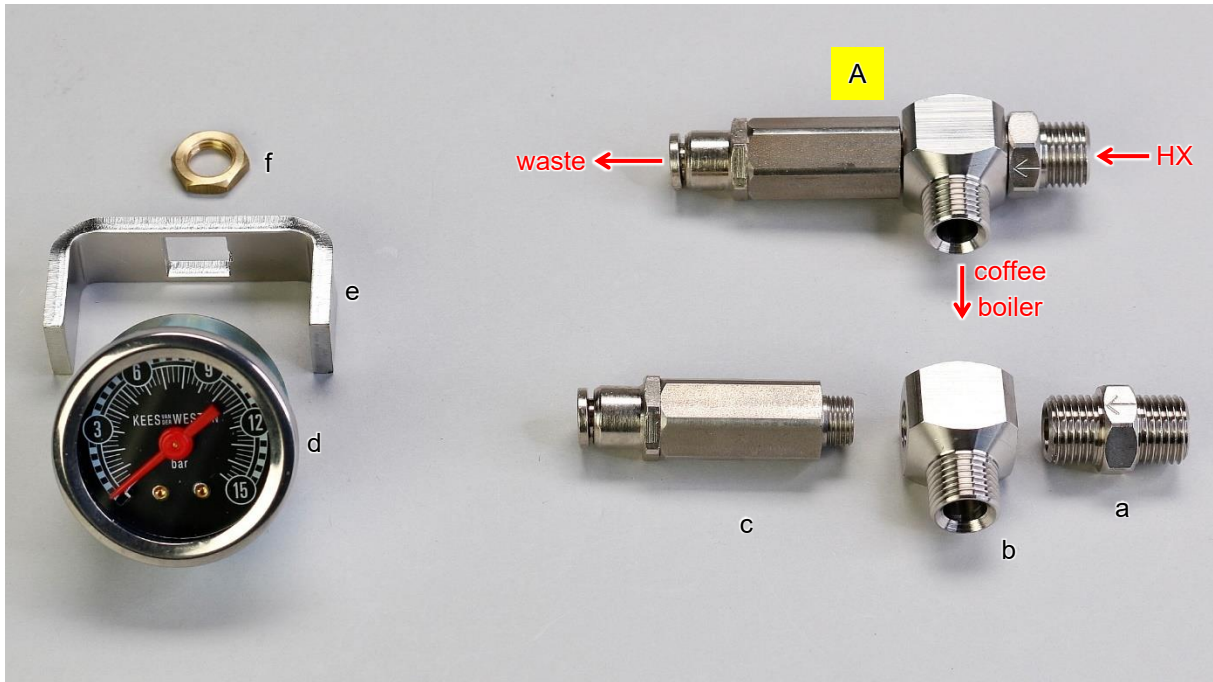

	part no.	short description	remark
A	K03110-01	Assembly: 1-way expansion valve/T-piece (push-fit)	
a	K02235-00	1-way valve 1/4M-1/4M; s.st.	
b	K02790-00	T-fitting, 1/4Mx1/8Fx1/4F; s.st.	
c	K03453-00	expansion valve 12bar, 1/8M-push-fit 6mm; s.st.	
d	K00790-00	pressure gauge 15 bar; KvdW marking	
e	K02289-00	bracket for pressure gauge; s.st. (SJ, S20, RE)	
f	K00820-00	flat nut 1/8"; brass	



## Water ways

### Water waste

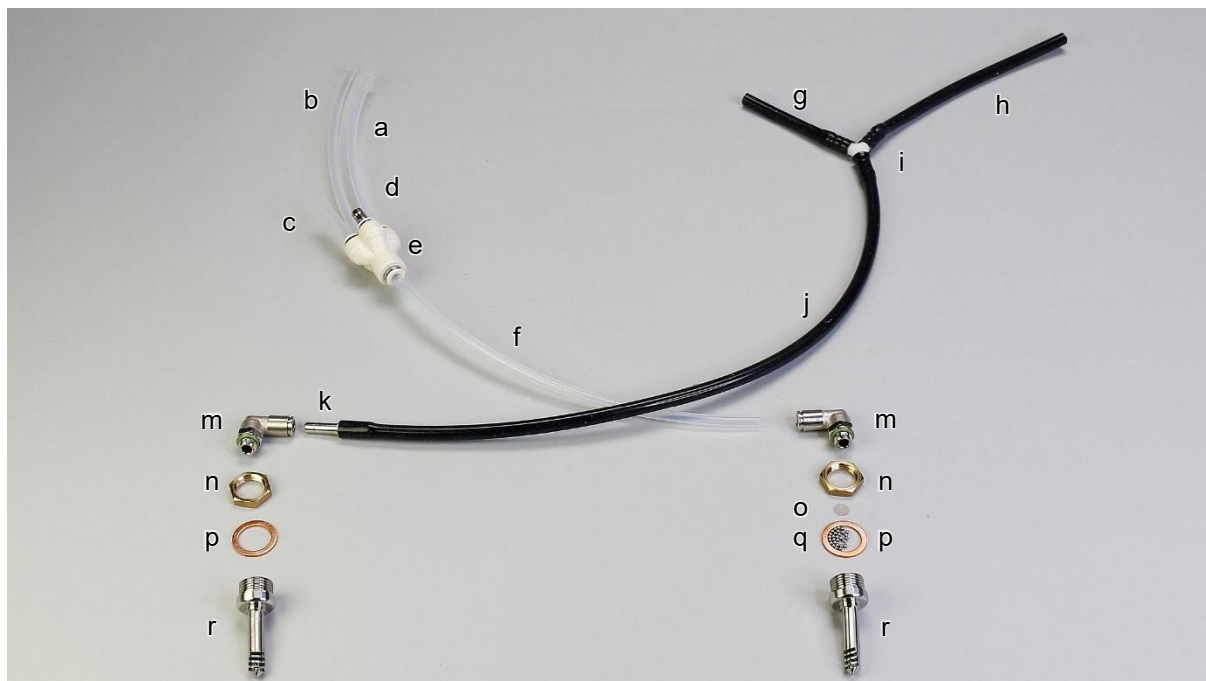

	part no.	short description	remark
a	K02288-00	push-in hose 4x6 mm; FEP, transparent, 170mm	group valve
b	K02288-00	push-in hose 4x6 mm; FEP, transparent, 195mm	drain valve
c	K02288-00	push-in hose 4x6 mm; FEP, transparent, 50mm	expansion valve
d	K02283-00	push-in stop plug, nickel plated brass, Ø6mm	
e	K03870-00	push-in adapter fitting 4-to-1 Ø6mm; plastic	
f	K02288-00	push-in hose 4x6 mm; FEP, transparent, 240mm	
g	C-HS-ZZ4X8	hose 4x8mm; black silicone, 80mm	overpressure valve
h	C-HS-ZZ4X8	hose 4x8mm; black silicone, 180mm	anti-vacuum valve
i	K01554-00	Y-shape hose connector 6mm; white POM	
j	C-HS-ZZ4X8	hose 4x8mm; black silicone, 440mm	
k	VK03420-00	push-in adapter, double sided 6mm; Ni plated brass	
m	K02152-00	push-in fitting, elbow 1/8M - 6mm; Ni plated brass	
n	K00680-00	flat nut 1/4; brass	
o	K00779-00	perforated screen for jet housing; s.st.	
p	K00784-00	ring 3/8"; copper	
q	C-TK-2	technical ball iso3290 D=2mm; s.st.	
r	K03616-01	drain outlet on inspection front; s.st. (RE)	



## Pressure

### Controller items

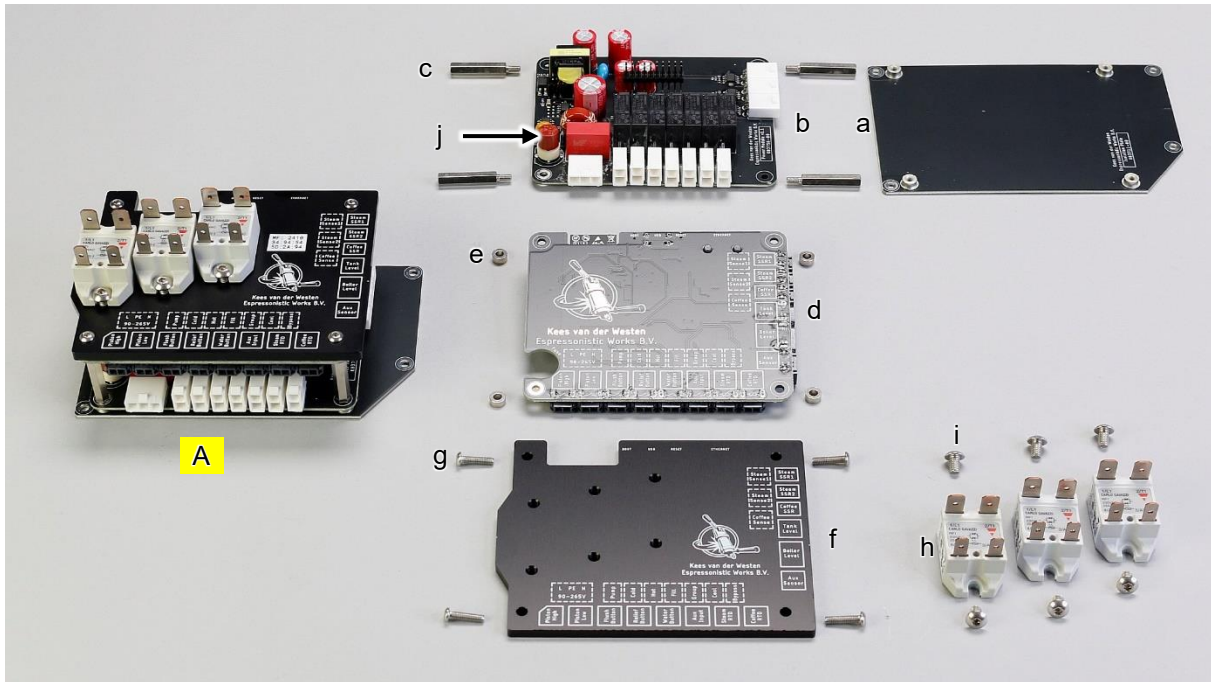

	part no.	short description	remark
A	K03717-01	Assemblage; complete controller with SSRs; Spiritello	
a	K03711-00	isolation plate; Spiritello controller; PCB material	
b	K03756-00	power module (lower PCB); Spiritello controller	
c	K03718-00	stand-off pillar, hex. M3x24, M-F; Ni plated brass (contr. RE)	
d	K03757-00.1	control module (upper PCB) v1.1; Spiritello controller	
e	K03715-00	spacer DoxDixH=6x3.2x3mm; Ni plated brass (controller RE)	
f	K03733-00	heatsink SSR; anodised aluminium (Spiritello controller)	
g	C-BI-M3X12	Allen screw Iso7380 M3x12; s.st.	
h	K00815-00	solid state relay; NO, 9-18Vdc control, mini (Carlo Gavazzi)	
i	C-BI-M4X06	Allen screw Iso7380 M4x6; s.st.	
j	K04011-00	fuse TR5 2A, time-lag, 230Vac, for controller (RE)	



Display

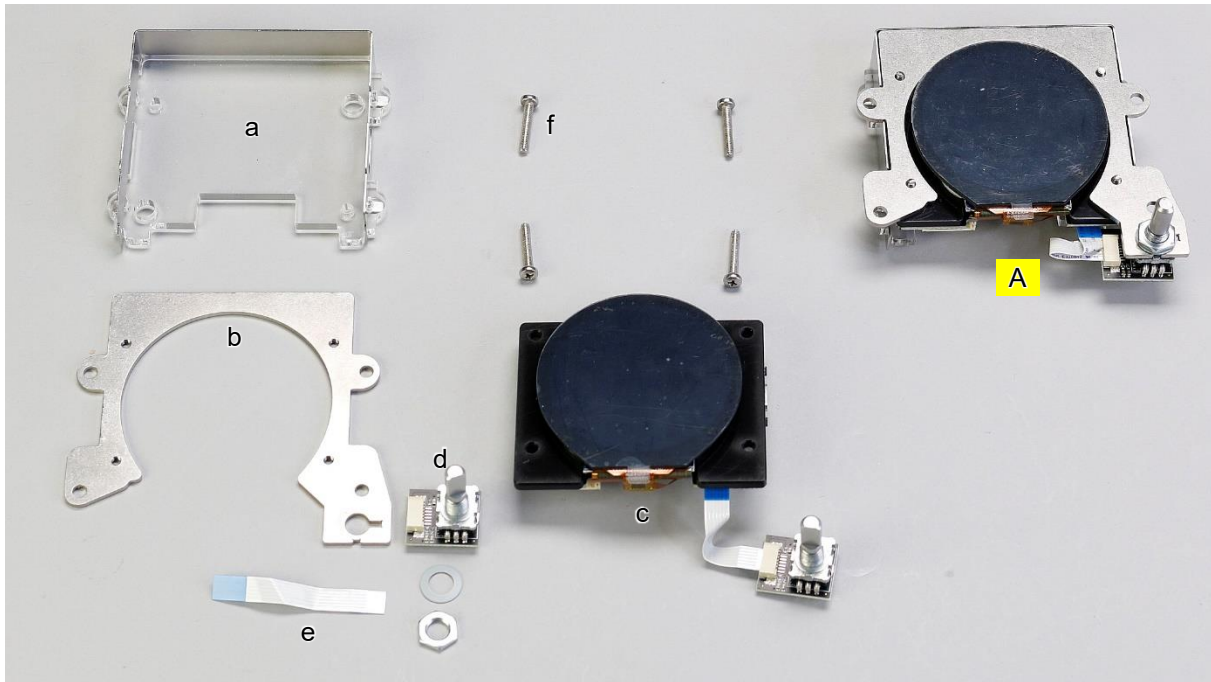

	part no.	short description	remark
A	K03774-01	Assembly: display + encoder modules; Spiritello	no knob
a	K03737-00	display housing Spiritello; s.st. 0.6mm	not sold individually
	K03738-00	cover for Spiritello display PCB; plexiglass 4mm	
b	K03735-00	mounting plate display and encoder Spiritello; s.st. 2mm	
c	K03755-00.1	PCB v1.1 for display Spiritello	not sold individually
	K03689-00	TFT LCD display Ø2.1", 480x480p (RE)	
	K03736-00	intermediate plate display Spiritello; POM 3mm	
d	K03754-00	encoder module; Spiritello	
e	K03716-00	flat cable WR-FFC 1mm, 50mm; encoder <-> display PCB (RE)	not sold individually
f	C-SK-M3X18	Phillips screw din7985 M3x18mm; s.st.	
nip	K03790-00	datacable display <-> controller Spiritello; LiYY 6x0.14	
	K04003-00	button cell battery CR2032	
	K03688-00	ornate knob for encoder (6mm axle); chromed brass	



## Pressure

### Other electrics

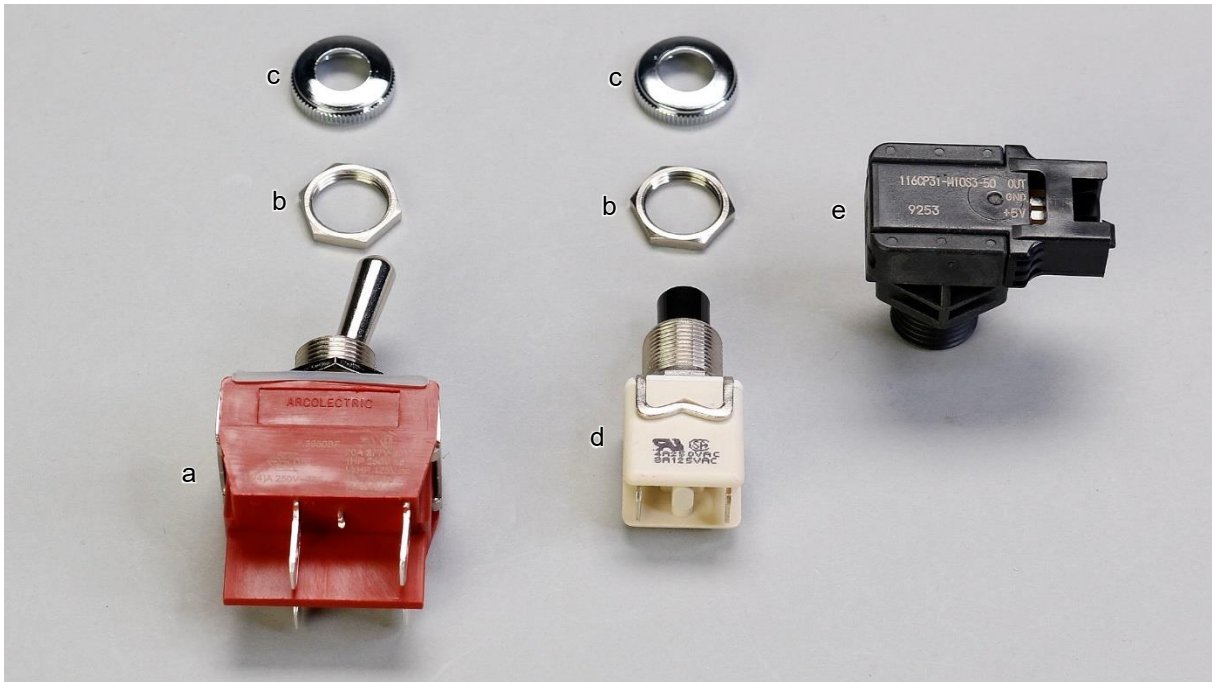

	part no.	short description	remark
a	K01606-01	toggle switch, DPST, OFF-ON, 16A/250V; mains on/off	with b & c
b	K00896-00	mounting nut for switches	
c	K00805-00	chrome plated nut for switches	
d	K00650-00	pushbutton switch, SPST, OFF-(ON), 4A/230V	with b & c
e		pressure sensor, 0-10 bar, 1/4M; plastic	see page <a href="#">29</a>



## Pressure

### Pressure sensing

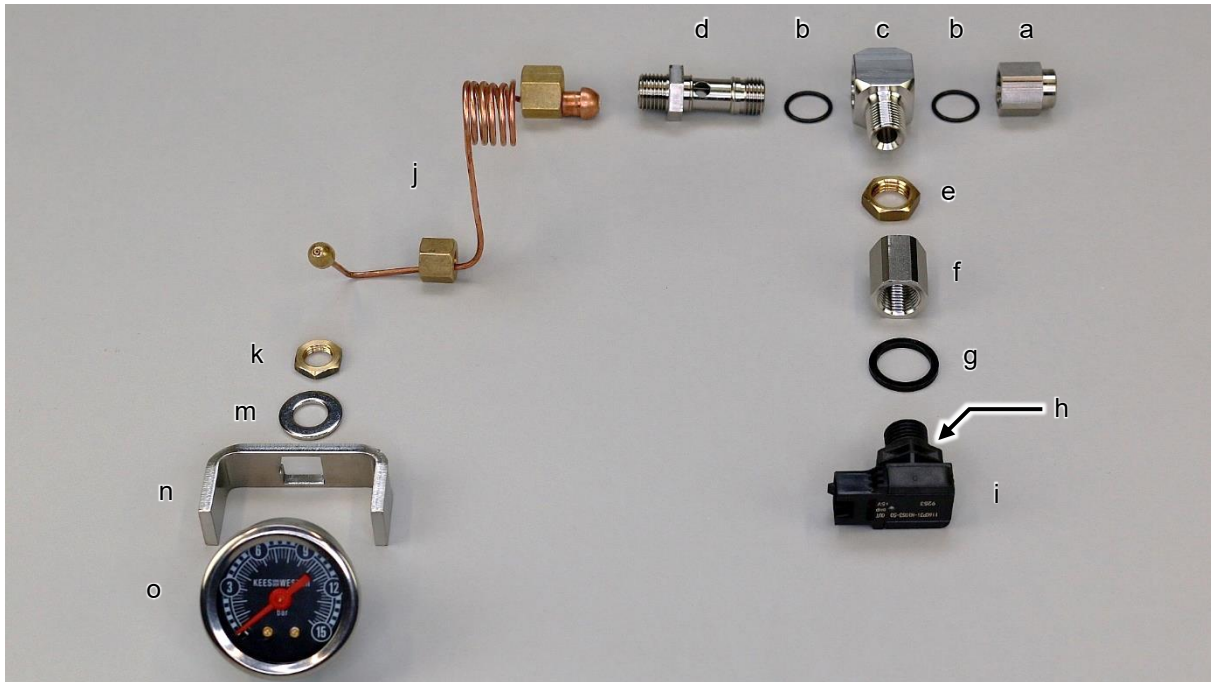

	part no.	short description	remark
a	K03954-00	adapterfitting 1/8F-1/4F; s.st.	
b	K02788-00	O-ring Ø13.5 x 1.5mm; CS FKM (Viton) 75 ShA FDA	
c	K02780-00	banjo fitting, 1/4"; s.st.	
d	K02779-00	banjo bolt, 1/4"; s.st.	
e	K00680-00	flat nut 1/4; brass	
f	K03778-00	socket 1/4"; s.st.; Spiritello	
g	K04027-00	spacer ring; 16,2x22x2; POM; pressure sensor	
h		O-ring Ø10.77x2.62mm; EPDM (seal on pressure sensor)	comes with sensor
	K03369-01	O-ring Ø10.77x2.62 mm FKM	
i	K03955-00	pressure sensor, 0-10 bar, 1/4M; plastic *	mV/bar = 400
nip		pressure sensor, 0-16 bar, 1/4M; plastic	mV/bar = 250
j	K00345-00	2mm copper tube; mix-block - pressure gauge, pump	
k	K00820-00	flat nut 1/8"; brass	
m	C-RS-M10	washer din125A M10; s.st.	
n	K02289-00	bracket for pressure gauge; s.st. (SJ, S20, RE)	
o	K00790-00	pressure gauge 15 bar; KvdW marking	

\* From machines with SN 101450725 onwards, the controller has changed such that the 0-10 bar sensor can only forward reliable pressure values up to 10.5 bar (was 11.3 bar).



## Tank

### Water tank

	part no.	short description	remark
	K03685-01	Assembly: water tank Spiritello	
	K03758-01	water tank Spiritello - body; s.st.	
	K03650-01	water tank supply flange; s.st. (RE)	
	C-RS-M5	washer din125A M5; s.st.	
	K03652-00	sensor-spacer and -seal; water tank; black PEEK (RE)	
	K03648-00T	isolation plate for water tank; black POM (RE)	
	K03759-01	lid for water tank Spiritello; s.st.	
	K03792-00	Allen key flat head cap nut type KT M5x9; s.st.	
	K03656-00	O-ring Ø34x2mm; FKM (water tank - RE)	
	K03655-00	O-ring Ø6x3.6mm; Silicone (water tank supply valve - RE)	
	K03654-00	conical spring in water tank supply valve (RE)	
	K03653-00	sealing plunger in water tank supply valve; plastic (RE)	
	C-BI-M3X08	Allen screw Iso7380 M3x8; s.st.	
	C-MH-M5	nut din934 M5; s.st.	
	C-TK-A4-M5X16	flange bolt ~din6921 M5x16; s.st. A4	
	K03764-00T	rear feet; water tank Spiritello; black POM	



## Body

### Body panels

	part no.	short description	remark
	K03854-00	body panel Spiritello left hand side; Alu 2mm, crackle black	contact us for other colours
	K03853-00	body panel Spiritello right hand side; Alu 2mm, crackle black	
	K03636-00	magnet Ø20x6mm M4F; rubber coating (RE)	
	K03722-00	slot bracket on body panel Spiritello (right); s.st.	
	C-BI-M4X06	Allen screw Iso7380 M4x6; s.st.	
		rear panel	see next page



## Body

### Rear panel

	part no.	short description	remark
	C-BI-M4X06	Allen screw Iso7380 M4x6; s.st.	
	C-BI-M5X06	Allen screw Iso7380 M5x6; s.st.	
	C-BI-M5X08	Allen screw Iso7380 M5x8; s.st.	
	C-BI-M5X12	Allen screw Iso7380 M5x12; s.st.	
	C-MH-M2,5	nut din934 M2.5; s.st.	
	C-RC-M3	fender washer din9021 M3; s.st.	
	C-SK-M2,5X16	Phillips screw din7985 M2.5x16; s.st.	
	K03341-00	boomerang spacer, rear panel Spiritello; black POM 3mm	
	K03585-00	moulded expanded metal panel, rear panel Spiritello; s.st., 1mm	
	K03594-00	logo-pin; rear panel Spiritello; metal alloy, black paint, 170x45x3.5mm	
	K03615-00	lower blind plate, rear panel Spiritello; s.st.	
	K03637-01	plastic filler plate, rear panel Spiritello; black POM, 1mm	
	K03645-00	inner plastic blind plate, rear panel Spiritello; black POM, 3mm	
	K03723-01	slot bracket for side panel, rear panel Spiritello; s.st.	
	K03903-00	lock-plate for K03723, rear panel Spiritello; s.st.	
	K03848-00	rear panel inner frame Spiritello; s.st. 2mm, crackle black	contact us for other colours
	K03849-01	rear panel center plate Spiritello; s.st. 2mm, crackle black	
	K03852-01	rear panel outer frame Spiritello; s.st. 2mm, crackle black	



## Tubing

### Copper tubing

	part no.	short description	remark
	K03694-00	set of copper tubing for Spiritello	a to m
a	K03668-00	6mm copper tube; pump - fill valve (RE)	
b	K03669-00	6mm copper tube; expansion valve - heat exchanger (RE)	
c	K03670-00	6mm copper tube; pressure reducer - expansion valve (RE)	
d	K03671-00	6mm copper tube; steam boiler - anti-vacuum valve (RE)	
e	K03672-00	6mm copper tube; steam boiler - mix block hot (RE)	
f	K03673-00	6mm copper tube; fill valve cold - mix block cold (RE)	
g	K03674-00	6mm copper tube; heat exchanger - coffee boiler (RE)	
h	K03675-00	6mm copper tube; mix block - hot water spout (RE)	
i	K03676-00	8mm copper tube; fill block - steam boiler (RE)	
j	K03677-00	8mm copper tube; steam boiler - steam valve (RE)	
k	K03678-00	6mm copper tube; injection 150mm long (RE)	
m	K00345-00	2mm copper tube; pressure sensor - pressure gauge (RE)	



## Portafilter

For parts that can be found on all our machines:

1. Portafilters and filter baskets:  
[www.keesvanderwesten.com/downloads/portafilters.pdf](http://www.keesvanderwesten.com/downloads/portafilters.pdf)

click the link above or copy-paste the address into your browser.

